

Hospital Map



Guiding

Patients & Visitors



Hospital Third & Fourth Floors

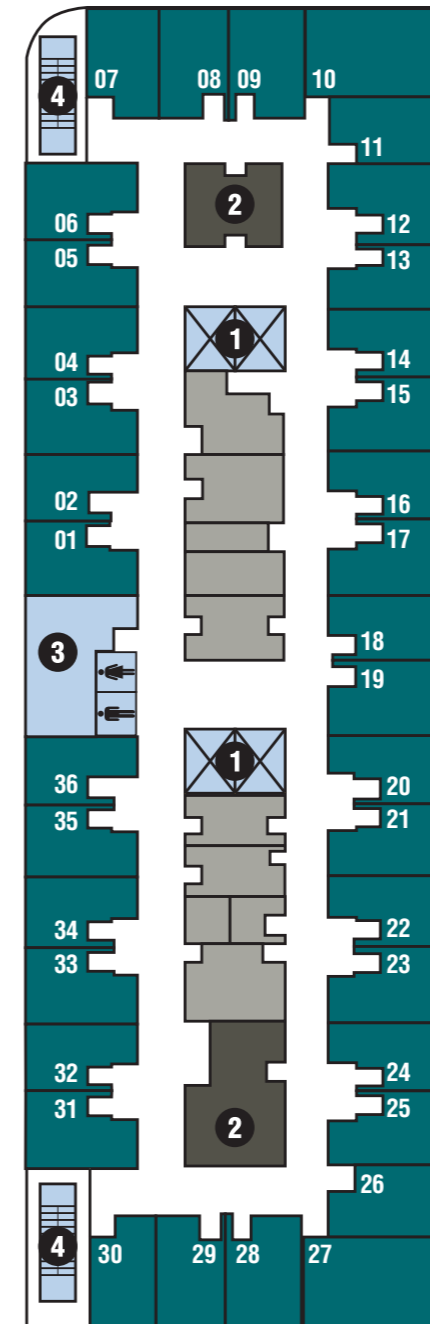

3rd Floor Rooms: 301-336
4th Floor Rooms: 401-436

- 1 Elevators
- 2 Nurses Station
- 3 Waiting Room
- 4 Stairwell
- Patient Rooms
- Admin/Staff

Women's Center 2nd Floor

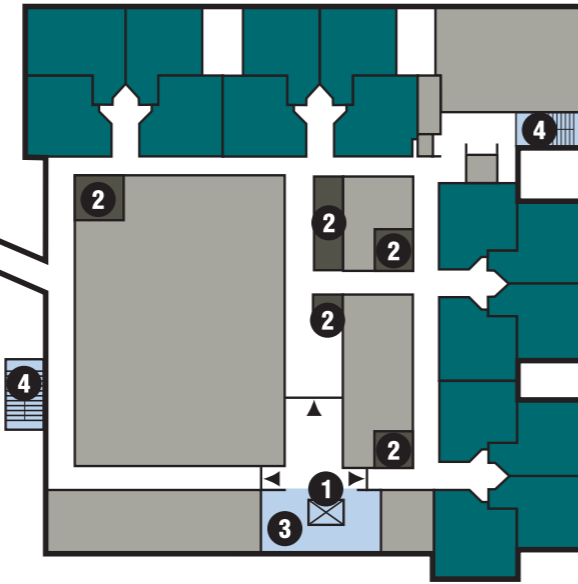

Women's Center 2nd Floor

- 1 Elevators
- 2 Nurses Station
- 3 Waiting Room (Wi-Fi Available)
- 4 Stairwell
- Patient Rooms
- Admin/Staff

Hospital 2nd Floor Rooms: 201-224/CHOP/GTC

- 1 Elevators
- 2 Nurses Station
- 3 Waiting Room
- 4 Stairwell
- Patient Rooms
- Admin/Staff
- 5 CHOP - Cancer Hematology Out-Patient
- GTC - Geriatric Transitional Care Center 216-224

Hospital Second Floor

